

# Tournesol VGM®

## *A modular living wall system designed for the life of the building*

The third generation VGM® is a 100% recycled plastic planting module, attached to stainless steel rails mounted to a wall or structure. Once grown in it provides instant, complete coverage of any vertical surface. A wide, controllable variety of plants can be used in nearly any horticultural condition.

Each planting module is available with a 4" or generous 8" soil profile. Because root growth isn't limited by restricting cells or baffles, plants grow healthier and stronger. Third-generation stainless steel hanging brackets require no screws or fasteners, install quickly and easily on planted modules, and allow for removal and maintenance off-site. The rails carry the load of the soil, and are easily mounted to either the wall or a framed sub-structure.



La Plaza, Los Angeles, CA

- Modular coverage allows for easy, off-site maintenance
- The only system with up to 8" of soil profile
- Designed, installed and maintained locally, with support from Tournesol Siteworks
- 100% post-consumer recycled plastic and stainless brackets for longevity

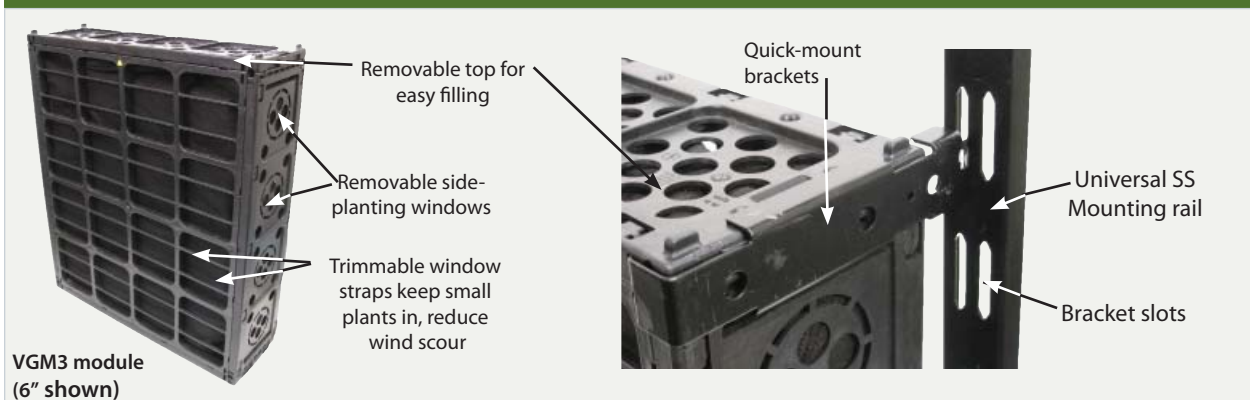

For more information about Tournesol VGM, visit [www.tournesolsiteworks.com/products/gr\\_vgm.asp](http://www.tournesolsiteworks.com/products/gr_vgm.asp)



**Tournesol**  
SITEWORKS

tournesolsiteworks.com  
800.542.2282

## The Tournesol VGM® system

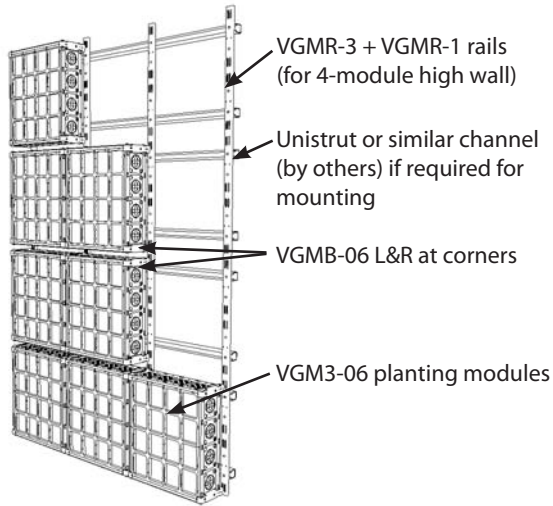

VGM Modules during grow-in (shown tilted at 45°)

### Specifying VGM®

Tournesol VGM® is typically installed with lightweight, mostly inorganic planting media. Organic components should comprise no more than 10% of the mix by volume, and the saturated media should weigh no more than 50 lbs/cu. ft. Automatic irrigation with integrated fertilization is highly recommended. Consult with a local horticulturalist for plant choices. Tournesol Siteworks has a design consultation service available should it be required. Simply ask your salesperson for details.

### VGM3 Living Wall Modules

Part No.	Overall Dimensions	Soil Profile	Media Volume	Empty Weight	Full Weight (w/ 50 lb/cu ft media)
VGM3-06	19-5/8"W x 22"H x 6"D	4"	0.85 cu. ft.	5 lbs.	47.5 lbs.
VGM3-10	19-5/8"W x 22"H x 10"D	8"	1.63 cu. ft.	7 lbs	88.5 lbs.

### VGM3 Brackets

Part No.	Description	Weight
VGMB-06 L&R	Powder coated SS304 brackets for VGM3-06 module, 2-L & 2-R required per module	6 lbs. (for all 4)
VGMB-10 L&R	Powder coated SS304 brackets for VGM3-10 module, 2-L & 2-R required per module	10 lbs (for all 4)

### VGM3 Rails

Part No.	Description
VGMR-1	SS304 mounting rail to hold 1 module - 1-1/2"W x 5/8"D x 23-1/2"L - use as end or middle rail
VGMR-2	SS304 mounting rail to hold 2 modules - 1-1/2"W x 5/8"D x 47-1/4"L - use as end or middle rail
VGMR-3	SS304 mounting rail to hold 3 modules - 1-1/2"W x 5/8"D x 70-7/8"L - use as end or middle rail



**BETWEEN** LANDSCAPE + ARCHITECTURE



**Tournesol**  
SITE WORKS

tournesolsiteworks.com  
800.542.2282